

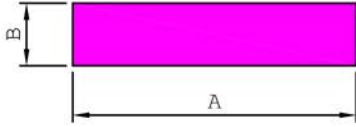

BARS & RODS

FLAT BARS



SL. No.	Section No.	A	B	Weight kg/m
1	10546	6.40	5.90	0.102
2	10171	8.00	2.00	0.043
3	10318	8.50	8.00	0.183
4	10277	10.00	8.00	0.216
5	10351	11.50	6.35	0.197
6	10001	12.00	2.00	0.065
7	10061	12.00	3.00	0.097
8	10164	12.00	4.00	0.130
9	10110	12.50	6.00	0.202
10	10036	12.70	5.00	0.171
11	S6088	12.70	6.40	0.219
12	10369	12.70	8.50	0.291
13	S6290	14.00	3.00	0.113
14	10153	15.00	2.00	0.081
15	10452	15.00	2.00	0.081
16	10087	15.00	3.00	0.122
17	10144	15.00	8.00	0.324
18	10103	15.00	8.55	0.346
19	10278	15.87	2.34	0.100
20	10135	16.95	4.15	0.190
21	10220	17.00	4.00	0.183
22	S4833	17.00	4.15	0.190
23	10160	17.50	1.80	0.085
24	10122	18.00	1.55	0.075
25	10109	18.00	2.50	0.121
26	S5415	18.00	3.00	0.145
27	10288	18.75	4.00	0.202
28	10279	19.00	1.82	0.093
29	10003	19.00	5.00	0.257
30	10035	19.00	9.50	0.487
31	10458	19.00	12.70	0.651
32	10123	19.05	2.25	0.116
33	10004	19.05	2.95	0.152
34	10005	19.05	3.18	0.163
35	10006	19.05	4.78	0.246
36	10007	19.05	6.35	0.327
37	S6189	19.50	14.50	0.763
38	10280	19.60	1.10	0.058
39	10118	20.00	1.60	0.086
40	10365	20.00	2.10	0.113
41	10008	20.00	3.00	0.162
42	10223	20.00	4.00	0.215
43	10065	20.00	5.00	0.270
44	10106	20.00	6.00	0.324
45	10009	20.00	8.00	0.432
46	10138	20.00	10.00	0.540
47	10302	20.00	15.00	0.810
48	10535	20.60	4.00	0.222
49	10500	21.00	18.00	1.020

SL. No.	Section No.	A	B	Weight kg/m
50	10129	22.00	2.00	0.118
51	10547	22.00	4.00	0.237
52	10408	22.35	2.81	0.169
53	10091	23.00	2.50	0.155
54	10545	24.00	4.00	0.259
55	10095	25.00	1.00	0.068
56	10116	25.00	1.50	0.101
57	10281	25.00	2.80	0.189
58	10010	25.00	3.00	0.203
59	10178	25.00	5.00	0.337
60	10011	25.00	6.00	0.405
61	10270	25.00	6.50	0.439
62	10107	25.00	8.00	0.540
63	10506	25.00	10.00	0.675
64	10197	25.00	15.00	1.013
65	10222	25.00	16.00	1.080
66	10075	25.40	2.00	0.137
67	10080	25.40	2.30	0.158
68	10012	25.40	2.95	0.202
69	10013	25.40	3.18	0.218
70	10411	25.40	3.18	0.218
71	10034	25.40	4.00	0.274
72	10014	25.40	6.35	0.435
73	10152	25.40	9.52	0.652
74	10102	25.40	12.75	0.874
75	10391	25.40	15.88	1.089
76	10191	25.40	19.05	1.304
77	10101	25.45	4.78	0.328
78	10094	27.00	15.00	1.093
79	10528	27.00	18.00	1.312
80	10396	27.00	24.00	1.749
81	10273	28.00	15.00	1.134
82	10530	29.00	20.00	1.566
83	10168	30.00	2.00	0.162
84	10265	30.00	2.90	0.235
85	10189	30.00	3.00	0.243
86	10015	30.00	5.00	0.405
87	10550	30.00	6.00	0.486
88	10142	30.00	8.00	0.648
89	10441	30.00	10.00	0.809
90	10375	30.00	13.00	1.053
91	10274	30.00	15.00	1.215
92	10195	30.00	20.00	1.620
93	10017	30.18	3.96	0.322
94	10079	31.75	2.30	0.197
95	10018	31.75	2.95	0.253
96	10347	31.75	3.18	0.272
97	10077	31.75	4.78	0.410
98	10019	31.75	6.35	0.544
99	10086	31.75	9.52	0.816
100	10524	31.75	12.70	1.088
101	10258	31.75	15.88	1.361
102	10198	31.75	19.05	1.633
103	10193	31.75	25.40	2.177
104	10409	31.85	3.18	0.273
105	10226	32.00	6.00	0.518
106	10227	32.00	10.00	0.864
107	10504	32.00	12.00	1.036

SL. No.	Section No.	A	B	Weight kg/m
108	10120	33.50	12.00	1.085
109	10539	34.00	15.00	1.377
110	10348	34.92	3.18	0.299
111	10211	35.00	2.96	0.279
112	10397	35.00	5.00	0.472
113	10243	36.00	2.65	0.257
114	10356	37.00	2.00	0.199
115	10477	38.00	1.50	0.154
116	10126	38.00	2.00	0.205
117	10190	38.00	3.00	0.308
118	10029	38.00	3.20	0.328
119	10181	38.00	5.00	0.513
120	10511	38.00	16.00	1.641
121	10336	38.00	20.00	2.052
122	10020	38.10	3.18	0.327
123	10410	38.10	3.18	0.327
124	10421	38.10	3.81	0.392
125	10033	38.10	4.78	0.492
126	10405	38.10	5.08	0.522
127	10021	38.10	6.35	0.653
128	10088	38.10	9.52	0.979
129	10104	38.10	12.70	1.306
130	10559	38.10	19.05	1.959
131	10199	38.10	25.40	2.613
132	10267	38.10	31.75	3.226
133	10140	40.00	1.60	0.173
134	10031	40.00	3.00	0.324
135	10047	40.00	4.00	0.432
136	10048	40.00	5.00	0.540
137	10503	40.00	6.00	0.648
138	10165	40.00	6.50	0.702
139	10148	40.00	8.00	0.864
140	10057	40.00	10.00	1.080
141	10083	40.00	12.00	1.296
142	10093	40.00	15.00	1.620
143	10466	40.00	16.00	1.728
144	10137	40.00	20.00	2.160
145	10529	40.00	32.00	3.456
146	10359	40.00	33.00	3.564
147	10459	41.50	4.00	0.448
148	10022	42.00	6.00	0.680
149	10562	42.00	20.00	2.267
150	10307	42.00	27.00	3.061
151	10555	42.50	2.80	0.321
152	10358	43.00	2.00	0.232
153	10373	44.00	16.00	1.900
154	10023	44.45	3.18	0.382
155	10366	44.45	12.70	1.524
156	10068	44.45	19.05	2.286
157	10218	44.45	25.40	3.048
158	10380	45.00	6.00	0.729
159	10162	45.00	25.00	3.037
160	12146	45.00	32.00	3.888
161	S6179	45.00	12.00	1.458
162	10067	47.00	2.00	0.254
163	10538	47.30	7.20	0.919
164	10143	50.00	3.00	0.405
165	10030	50.00	4.00	0.540
166	10072	50.00	5.00	0.675



BARS & RODS

FLAT BARS

SL. No.	Section No.	A	B	Weight kg/m
167	10069	50.00	6.00	0.810
168	10251	50.00	6.50	0.877
169	10100	50.00	8.00	1.080
170	10042	50.00	10.00	1.350
171	10232	50.00	12.00	1.619
172	10113	50.00	13.70	1.850
173	10145	50.00	15.00	2.025
174	10286	50.00	20.00	2.700
175	10379	50.00	30.00	4.050
176	10510	50.80	3.18	0.436
177	10024	50.80	6.35	0.870
178	10037	50.80	9.52	1.306
179	10038	50.80	12.70	1.742
180	10071	50.80	15.88	2.178
181	10200	50.80	19.05	2.613
182	10217	50.80	25.40	3.483
183	10475	50.80	32.00	4.389
184	10467	50.80	38.10	5.225
185	10259	50.80	44.45	6.096
186	10515	51.00	46.00	6.334
187	10527	52.00	42.00	5.896
188	10256	54.00	3.30	0.481
189	10541	54.00	45.00	6.561
190	S6105	55.00	8.00	1.188
191	10173	55.00	35.00	5.198
192	10201	57.15	12.70	1.960
193	10487	59.00	21.00	3.345
194	10293	59.54	6.35	1.020
195	10312	59.95	3.33	0.539
196	10053	60.00	6.00	0.972
197	10039	60.00	10.00	1.620
198	10505	60.00	15.00	2.430
199	10196	60.00	20.00	3.240
200	10156	60.00	30.00	4.860
201	10480	60.30	32.00	5.210
202	10208	61.00	43.00	7.082
203	10389	63.00	8.00	1.360
204	10390	63.00	12.00	2.041
205	10184	63.00	38.00	6.464
206	10325	63.50	4.76	0.816
207	10025	63.50	6.35	1.089
208	10073	63.50	9.52	1.632
209	10468	63.50	12.70	2.177
210	10494	63.50	15.88	2.722
211	10202	63.50	19.05	3.266
212	10192	63.50	22.22	3.810
213	10194	63.50	25.40	4.355
214	10260	63.50	31.75	5.443
215	10203	63.50	44.45	7.621
216	10268	63.50	50.80	8.709
217	10050	64.00	12.00	2.074
218	10413	64.00	34.00	5.875
219	10368	64.50	4.00	0.696
220	10131	65.00	50.00	8.775
221	10098	66.00	9.00	1.604
222	10295	66.50	14.20	2.550
223	10551	69.85	31.75	5.988
224	10216	69.85	50.80	9.580
225	10343	69.90	64.00	12.078

SL. No.	Section No.	A	B	Weight kg/m
226	10225	70.00	3.18	0.601
227	10552	70.00	6.00	1.134
228	10245	70.00	12.00	2.268
229	10331	70.00	20.00	3.780
230	10188	70.00	30.00	5.670
231	10482	70.00	40.00	7.560
232	10206	72.00	52.00	10.109
233	10269	73.00	2.70	0.532
234	S5886	75.00	3.00	0.607
235	10166	75.00	5.00	1.013
236	10382	75.00	6.00	1.215
237	10332	75.00	8.00	1.620
238	10125	75.00	10.00	2.025
239	10084	75.00	12.00	2.430
240	10111	75.00	12.50	2.531
241	10540	75.00	27.00	5.467
242	10052	76.00	15.00	3.078
243	10026	76.20	6.35	1.306
244	10059	76.20	9.52	1.958
245	10058	76.20	12.70	2.613
246	10476	76.20	16.00	3.291
247	10204	76.20	19.05	3.919
248	S6274	76.00	20.00	4.104
249	10285	76.20	25.40	5.225
250	10205	76.20	31.75	6.532
251	10315	76.20	38.10	7.838
252	10362	76.20	50.80	10.451
253	10518	76.20	63.50	13.064
254	10287	80.00	4.00	0.864
255	10520	80.00	5.00	1.080
256	10049	80.00	6.00	1.296
257	10054	80.00	8.00	1.728
258	10060	80.00	10.00	2.160
259	10531	80.00	12.00	2.592
260	10537	80.00	15.00	3.240
261	10261	80.00	20.00	4.320
262	10544	80.00	25.00	5.400
263	10154	80.00	30.00	6.480
264	10130	80.00	70.00	15.120
265	10489	82.00	2.00	0.442
266	10542	85.00	32.00	7.344
267	10133	85.00	65.00	14.918
268	10478	85.00	68.00	15.606
269	10136	85.72	34.92	8.082
270	10490	86.00	2.00	0.464
271	10554	87.00	9.00	2.114
272	10236	88.00	45.00	10.692
273	10404	88.90	25.40	6.096
274	10560	88.90	38.10	9.145
275	10321	88.90	76.20	18.290
276	10367	89.20	20.00	4.816
277	10516	89.50	44.50	10.753
278	10497	90.00	12.00	2.916
279	10556	90.00	25.00	6.075
280	10350	90.00	30.00	7.290
281	10353	91.00	8.00	1.965
282	S5358	95.00	4.00	1.026
283	10117	95.00	5.00	1.282
284	10415	98.00	7.80	2.064

SL. No.	Section No.	A	B	Weight kg/m
285	10486	100.00	1.50	0.450
286	10383	100.00	6.00	1.620
287	10376	100.00	8.00	2.160
288	10064	100.00	10.00	2.700
289	10045	100.00	12.00	3.240
290	10082	100.00	12.50	3.375
291	10055	100.00	15.00	4.050
292	10096	100.00	20.00	5.400
293	10147	100.00	25.00	6.750
294	10324	100.00	30.00	8.100
295	10186	100.00	50.00	13.500
296	10499	100.00	70.00	18.900
297	10158	100.00	80.00	21.600
298	10305	100.30	16.00	4.333
299	10028	101.60	6.35	1.742
300	10349	101.60	3.18	0.872
301	10046	101.60	12.70	3.484
302	10534	101.60	19.05	5.225
303	10215	101.60	22.22	6.095
304	10214	101.60	25.40	6.967
305	10469	101.60	32.00	8.778
306	10470	101.60	40.00	10.972
307	10262	101.60	50.80	13.935
308	10561	101.60	38.10	10.451
309	10361	101.60	76.20	20.903
310	10304	102.00	36.00	9.914
311	10276	102.00	82.00	22.583
312	10424	103.00	7.40	2.058
313	10406	103.00	43.00	11.958
314	10309	103.00	53.00	14.739
315	10363	103.00	63.00	17.520
316	10310	103.50	6.80	1.899
317	10423	105.00	5.00	1.417
318	10043	105.00	15.00	4.253
319	10301	107.50	2.65	0.769
320	10090	110.00	12.00	3.564
321	10169	110.00	30.00	8.910
322	10235	112.00	60.00	18.144
323	10496	114.30	9.53	2.941
324	10239	115.00	3.30	1.025
325	10127	115.00	25.00	7.762
326	10257	115.00	60.00	18.630
327	10308	117.00	42.00	13.267
328	10374	118.00	31.00	9.876
329	10395	120.00	4.00	1.296
330	10393	120.00	6.00	1.944
331	10394	120.00	8.00	2.592
332	10051	120.00	10.00	3.240
333	10124	120.00	25.00	8.100
334	10444	120.00	69.00	22.356
335	10355	120.00	80.00	25.920
336	10402	120.00	95.00	30.780
337	10163	121.00	12.00	3.920
338	10299	122.00	12.70	4.183
339	10298	122.00	17.00	5.600
340	10271	122.00	38.10	12.550
341	10303	123.00	2.90	0.963
342	10548	123.00	15.00	4.981
343	10445	125.00	6.00	2.025



BARS & RODS

FLAT BARS

SL. No.	Section No.	A	B	Weight kg/m
344	10436	125.00	10.00	3.375
345	S6206	125.00	15.00	5.062
346	10498	125.00	20.00	6.750
347	10228	125.00	50.80	17.145
348	10213	127.00	3.00	1.028
349	10076	127.00	6.35	2.177
350	10041	127.00	9.52	3.264
351	10151	127.00	12.70	4.355
352	10488	127.00	15.88	5.445
353	10471	127.00	20.00	6.858
354	10472	127.00	25.40	8.709
355	10473	127.00	32.00	10.972
356	10474	127.00	40.00	13.716
357	10263	127.00	50.80	17.419
358	10159	127.00	76.20	26.129
359	10317	130.00	10.00	3.510
360	10172	130.00	13.00	4.563
361	10283	130.00	65.00	22.815
362	10407	132.00	19.00	6.771
363	10519	134.00	10.00	3.618
364	10230	135.00	44.45	16.202
365	10231	135.00	82.55	30.089
366	10417	136.00	4.80	1.762
367	10403	136.00	43.00	15.789
368	10420	137.00	4.60	1.701
369	10300	137.00	20.00	7.398
370	10132	140.00	10.00	3.780
371	10316	140.00	15.80	5.972
372	10442	140.00	16.50	6.237
373	10170	140.00	50.00	18.900
374	10492	140.00	57.00	21.546
375	10558	141.00	32.00	12.182
376	S6161	141.50	10.00	3.820
377	10085	150.00	6.00	2.430
378	10128	150.00	7.50	3.037
379	10292	150.00	8.00	3.240
380	10066	150.00	10.00	4.050
381	10089	150.00	12.00	4.860
382	10294	150.00	16.00	6.480
383	10097	150.00	19.00	7.695
384	10174	150.00	20.00	8.100
385	10070	150.00	25.00	10.125
386	10134	150.00	30.00	12.150
387	10185	150.00	40.00	16.200
388	10249	150.00	45.00	18.225
390	10517	150.00	50.00	20.250
391	10284	150.00	75.00	30.375
392	10105	152.40	6.40	2.633
393	10179	152.40	12.70	5.225
394	10557	152.40	19.05	7.838
395	10252	152.40	31.75	13.064
396	10264	152.40	50.80	20.903
397	10360	152.40	63.50	26.129
398	10451	152.40	101.60	41.806
399	10176	154.00	2.00	0.832
400	10522	154.00	12.60	5.239
401	10352	158.00	8.50	3.626
402	10443	158.00	16.00	6.825

SL. No.	Section No.	A	B	Weight kg/m
403	10229	158.00	35.00	14.930
404	10401	159.00	3.00	1.288
405	10250	160.00	6.00	2.592
406	10418	160.00	6.40	2.764
407	10533	160.00	8.00	3.455
408	10523	160.00	10.00	4.320
409	10247	160.00	18.00	7.776
410	10167	160.00	25.00	10.800
411	10525	160.00	45.00	19.440
412	10526	160.00	50.00	21.600
413	10240	160.00	55.00	23.800
414	10115	162.00	10.00	4.374
415	10238	165.00	14.00	6.236
416	10549	165.00	15.00	6.682
417	10493	165.00	50.00	22.275
418	10297	167.00	22.00	9.920
419	10319	167.00	30.00	13.527
420	10320	167.00	68.00	30.661
421	10387	170.00	12.00	5.508
422	10543	170.00	20.00	9.180
423	10221	170.00	32.00	14.688
424	10272	172.00	12.00	5.572
425	10233	173.00	14.00	6.539
426	10398	175.00	3.00	1.417
427	10187	175.00	50.00	23.625
428	10210	175.00	52.00	24.570
429	10507	175.00	65.00	30.712
430	10501	177.00	16.00	7.646
431	10392	177.80	9.52	4.570
432	10254	178.00	10.50	5.045
433	10244	178.00	19.50	9.371
434	10484	180.00	15.00	7.290
435	10412	180.00	19.00	9.234
436	10182	180.00	40.00	19.440
437	10183	190.00	4.00	2.052
438	10209	190.00	50.00	25.650
439	10483	190.50	9.53	4.901
440	10313	195.00	30.00	15.795
441	10536	200.00	8.00	4.320
442	10326	200.00	8.00	4.320
443	10255	200.00	10.00	5.400
444	10502	200.00	12.00	6.480
445	10180	200.00	13.00	7.020
446	10485	200.00	15.00	8.100
447	10341	200.00	25.00	13.500
448	10514	200.00	40.00	21.600
449	10266	203.20	12.70	6.967
450	10289	203.00	16.00	8.770
451	10224	204.00	5.00	2.754
452	10237	208.00	45.00	25.272
453	10333	210.00	12.00	6.804
454	10338	210.00	15.00	8.505
455	10495	220.00	8.00	4.752
456	10381	220.00	16.00	9.504
457	10426	222.00	4.75	2.847
458	10425	222.00	5.90	3.536
459	10455	222.00	10.25	6.143
460	10521	227.00	91.00	55.774

SL. No.	Section No.	A	B	Weight kg/m
461	10323	228.60	26.50	16.356
462	10400	229.00	19.00	11.747
463	10453	230.00	5.00	3.105
464	10371	230.00	6.00	3.726
465	10431	230.00	9.75	6.054
466	10440	230.00	112.00	69.552
467	10334	232.00	42.00	26.308
468	10491	235.00	152.00	96.444
469	10290	238.00	16.00	10.282
470	10508	240.00	90.00	58.320
471	10386	244.00	7.00	4.611
472	10433	245.00	5.25	3.473
473	10241	245.00	18.00	11.907
474	10330	246.00	20.00	13.284
475	10327	250.00	10.00	6.750
476	10481	250.00	12.00	8.100
477	10435	250.00	19.00	12.825
478	S5645	250.00	60.00	40.500
479	10354	250.00	100.00	67.500
480	10454	252.00	10.30	7.008
481	10346	254.00	12.70	8.709
482	10385	254.00	25.40	17.419
483	10447	255.00	6.25	4.303
484	10430	258.00	6.80	4.737
485	10427	258.00	7.40	5.154
486	10429	258.00	7.40	5.154
487	10439	258.00	9.75	6.791
488	10242	258.00	18.00	12.539
489	10448	258.00	7.50	5.224
490	10449	258.00	9.00	6.269
491	10460	258.00	10.00	6.966
492	10532	260.00	6.00	4.212
493	10428	262.00	8.00	5.659
494	10340	270.00	10.00	7.290
495	10357	285.00	16.00	12.312
496	10329	290.00	20.00	15.660
497	10553	290.00	4.00	3.131
498	10384	300.00	25.00	20.250
499	10388	300.00	28.00	22.680
500	10322	304.80	26.50	21.808
501	10450	305.00	14.00	11.529
502	10509	305.00	16.00	13.176
503	10513	305.00	18.00	14.823
504	10342	312.00	8.00	6.739
505	10364	316.50	23.50	20.082
506	10314	320.00	20.00	17.280
507	10370	340.00	22.00	20.196
508	10378	350.00	22.50	21.262
509	10377	351.00	30.50	28.904
510	10512	425.00	8.20	9.409
511	10479	425.00	25.00	28.687



FLAT BAR WITH RADIUS

FLAT BAR WITH RADIUS

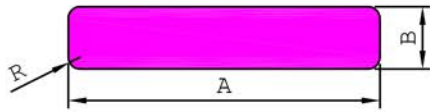

SL. No.	Section No.	A	B	R	Weight kg/m
1	S6117	17.47	8.25	1.60	0.383
2	S6118	25.40	8.25	1.60	0.560
3	12280	28.00	9.00	1.50	0.675
4	S6193	28.70	25.40	2.50	1.954
5	S5981	30.00	10.00	3.00	0.789
6	12180	30.00	16.00	1.00	1.294
7	12258	40.00	10.00	0.80	1.079
8	12134	40.00	10.00	3.00	1.059
9	12279	40.00	11.00	1.50	1.183
10	12147	40.00	26.00	3.00	2.787
11	12217	50.00	8.00	3.00	1.059
12	12135	50.00	10.00	3.00	1.329
13	12096	50.00	12.00	3.00	1.599
14	12311	50.00	40.00	1.00	5.398
15	12186	50.05	8.00	3.00	1.060
16	S6250	54.50	30.00	2.25	4.403
17	12278	55.00	15.00	2.00	2.218
18	12307	60.00	8.00	1.00	1.294
19	12128	60.00	10.00	1.00	1.618
20	12136	60.00	10.00	3.00	1.559
21	12290	63.00	54.00	1.00	9.183
22	12092	65.00	8.00	3.00	1.383
23	12215	65.00	8.00	3.00	1.383
24	12185	65.05	8.00	3.00	1.384
25	12243	75.00	10.00	3.00	2.004
26	12023	80.00	10.00	3.00	2.138
27	12265	80.00	40.00	0.60	8.639
28	S6073	85.00	47.00	2.00	10.777
29	12200	88.90	50.80	1.00	12.191
30	12201	88.90	63.50	1.00	15.240
31	12131	90.00	75.00	0.50	18.225
32	12304	93.00	67.00	0.80	16.822
33	S5424	95.00	45.00	10.00	11.311
34	12305	95.00	88.00	0.80	22.571
35	12137	100.00	10.00	3.00	2.679
36	12114	100.00	12.00	3.00	3.219
37	12069	101.60	9.52	1.50	2.606
38	12199	101.60	15.88	1.00	4.354
39	12206	101.60	44.45	1.00	12.191
40	12323	110.00	3.00	1.00	0.889
41	12250	110.50	12.00	1.00	3.578
42	12212	110.50	77.00	1.00	22.971
43	12202	114.30	88.90	1.00	27.433
44	12165	115.00	79.00	1.00	24.527
45	12172	116.00	88.00	1.00	27.559
46	12141	120.00	10.00	3.00	3.219
47	12113	120.00	12.00	3.00	3.867
48	12115	120.00	16.00	3.00	5.163

SL. No.	Section No.	A	B	R	Weight kg/m
49	12105	120.00	45.00	1.00	14.578
50	12080	120.00	100.00	2.00	32.391
51	12312	125.00	50.00	3.00	16.854
52	12289	125.00	95.00	1.00	32.060
53	12317	127.00	38.10	1.00	13.062
54	12203	127.00	101.60	1.20	34.835
55	12124	130.00	17.00	1.00	5.965
56	12091	130.00	100.00	1.00	35.098
57	12298	130.00	105.00	1.00	36.853
58	12138	140.00	10.00	3.00	3.759
59	12263	140.00	40.00	1.00	15.118
60	12262	140.00	90.00	1.00	34.018
61	12145	140.00	110.00	1.00	41.578
62	12221	144.00	74.00	2.00	28.762
63	12133	145.00	4.80	1.00	1.877
64	12252	145.00	27.00	1.00	10.568
65	12251	145.00	68.00	1.00	26.620
66	12224	150.00	22.00	1.00	8.908
67	12230	150.00	100.00	1.00	40.498
68	12219	151.00	7.80	2.00	3.171
69	12104	151.00	111.00	2.00	45.245
70	12253	152.00	16.00	1.00	6.564
71	12127	152.00	80.00	1.00	32.830
72	12303	152.40	25.40	1.00	10.449
73	12318	152.40	38.10	1.00	15.675
74	12205	152.40	76.20	1.00	31.352
75	12232	155.00	13.00	1.00	5.438
76	12130	155.00	58.00	1.00	24.271
77	12098	160.00	10.00	3.00	4.299
78	12255	160.00	115.00	1.00	49.678
79	12179	161.00	40.00	1.00	17.386
80	12171	163.00	39.00	1.00	17.162
81	12260	165.00	6.35	3.00	2.808
82	12264	165.00	55.00	1.00	24.500
83	12055	165.00	85.00	2.00	37.858
84	12160	165.00	120.00	1.00	53.458
85	12140	168.00	133.00	1.00	60.326
86	12132	169.00	4.80	1.00	2.188
87	S5203	169.00	7.80	2.00	3.550
88	12169	170.00	77.00	1.00	35.341
89	12259	170.00	80.00	2.00	36.711
90	12109	180.00	10.00	3.00	4.839
91	12242	180.00	30.00	2.00	14.571
92	12241	180.00	63.00	1.00	30.616
93	12071	185.00	15.00	1.00	7.490
94	12283	200.00	6.00	0.70	3.239
95	12139	200.00	10.00	3.00	5.379
96	12268	200.00	20.00	0.50	10.799
97	12065	200.00	20.00	1.00	10.800
98	12285	200.00	22.00	1.00	11.878
99	12118	200.00	32.00	1.00	17.278
100	12226	200.00	55.00	2.00	29.691
101	12190	203.00	52.00	1.00	28.499

FLAT BAR WITH RADIUS & CHAMFER

SL. No.	Section No.	A	B	R	Weight kg/m
102	12191	203.00	62.00	1.00	33.980
103	12087	203.20	9.52	3.00	5.202
104	12284	203.20	101.60	1.00	55.740
105	12207	204.00	26.00	2.00	14.312
106	12070	205.00	15.00	1.00	8.300
107	12204	208.00	12.70	1.00	7.130
108	12083	212.00	38.00	2.00	21.742
109	12177	215.00	76.20	1.00	44.232
110	12173	220.00	12.30	2.00	7.297
111	12078	222.00	32.00	1.50	19.176
112	12103	223.00	18.00	1.00	10.835
113	12213	225.00	50.00	2.00	30.366
114	12308	230.00	65.00	1.00	40.363
115	12074	233.00	17.00	1.00	10.692
116	12084	250.00	18.00	1.50	12.145
117	12054	250.00	30.00	2.50	20.236
118	12167	254.00	21.50	1.00	14.742
119	12266	254.00	50.80	0.60	34.838
120	12097	255.00	17.50	1.50	12.044
121	12063	255.00	23.00	1.00	15.833
122	12090	256.00	4.82	2.00	3.322
123	12088	256.00	9.52	2.00	6.571
124	12188	260.00	22.00	2.00	15.435
125	12081	260.00	23.00	2.00	16.137
126	12110	265.00	18.00	2.00	12.879
127	12235	267.00	22.00	2.00	15.851
128	12293	268.00	18.00	3.00	13.004
129	12196	270.00	22.00	4.00	16.001
130	12064	276.00	23.00	2.00	17.130
131	12082	284.00	18.00	2.00	13.793
132	12085	285.00	23.00	2.00	17.699
133	12320	290.00	15.00	1.00	11.743
134	12195	290.00	29.00	4.00	22.670
135	12236	292.00	23.00	4.00	18.096
136	12222	300.00	36.00	1.00	29.158
137	12056	305.00	6.00	1.00	4.939
138	12057	305.00	8.00	1.00	6.586
139	12197	305.00	20.00	1.00	16.468
140	12267	380.00	10.00	1.00	10.258
141	S5429	400.00	45.00	1.00	48.598
142	12218	425.00	5.00	1.00	5.735
143	12244	426.00	30.00	6.00	34.423

FLAT BAR WITH CHAMFER

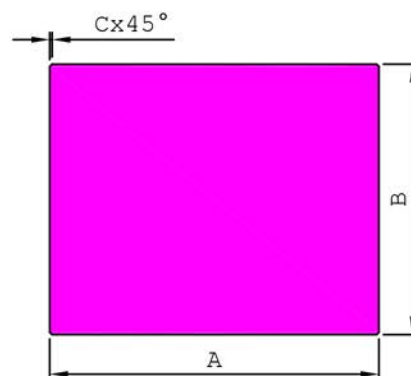

SL. No.	Section No.	A	B	C	Weight kg/m
1	12301	101.60	78.00	2.00	21.375
2	12300	114.30	50.80	2.00	15.656
3	12291	118.00	75.00	2.00	23.873
4	12310	140.00	115.00	1.00	43.465
5	12292	146.00	75.00	2.00	29.543
6	12315	153.00	55.00	1.50	22.708
7	S5777	124.00	124.00	1.00	41.510

MISCELLANEOUS BARS

FLAT BAR WITH FULL RADIUS

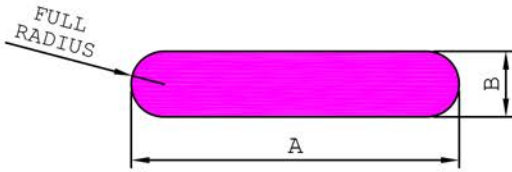

SL. No.	Section No.	A	B	Weight kg/m
1	S5642	20.00	3.00	0.157
2	S5587	25.00	6.00	0.384
3	12030	25.20	6.30	0.405
4	12316	25.40	4.76	0.313
5	12209	30.00	13.00	0.955
6	12261	32.00	9.00	0.731
7	12302	40.00	6.00	0.627
8	12039	40.00	10.00	1.022
9	12231	40.00	15.00	1.490
10	12269	50.00	5.00	0.661
11	12117	50.00	6.00	0.789
12	12001	50.00	10.00	1.292
13	12111	50.00	12.00	1.537
14	12046	50.40	6.30	0.834
15	12297	55.00	25.60	3.422
16	12229	60.00	5.00	0.796
17	12245	60.00	6.00	0.951
18	12075	60.00	6.20	0.982
19	12270	60.00	8.00	1.259
20	12198	61.00	7.50	1.203
21	12322	70.00	5.00	0.931
22	12116	75.00	6.00	1.194
23	12150	76.20	9.52	1.906
24	S5588	76.20	12.70	2.519
25	12234	80.00	3.00	0.643
26	12271	80.00	8.00	1.691
27	12100	100.00	6.00	1.599
28	12246	100.00	6.00	1.599
29	12272	100.00	8.00	2.123
30	12144	100.00	12.00	3.157
31	12050	101.60	6.35	1.720
32	12238	120.00	3.00	0.967
33	12237	120.00	5.00	1.606
34	12273	120.00	8.00	2.555
35	12274	120.00	12.00	3.805
36	12227	140.00	6.00	2.247
37	12102	150.00	6.00	2.409
38	12193	150.00	10.00	3.992
39	12042	152.40	6.35	2.590
40	12275	160.00	10.00	4.262
41	12276	160.00	14.00	5.934
42	12239	175.00	6.00	2.814
43	12228	185.00	6.00	2.976
44	12319	200.00	10.00	5.342
45	12068	200.00	12.00	6.397

SL. No.	Section No.	A	B	Weight kg/m
46	12208	240.00	6.00	3.867
47	12216	240.00	6.00	3.867
48	12192	300.00	10.00	8.042

FLAT BAR WITH FULL RADIUS

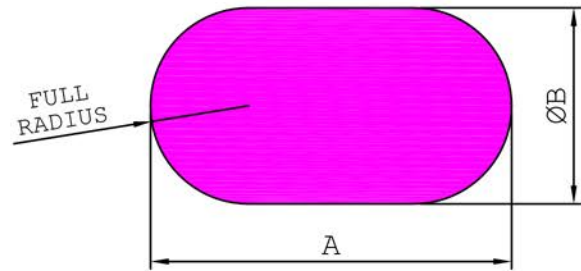

SL. No.	Section No.	A	B	Weight kg/m
1	28328	37.00	16.00	1.450
2	28215	49.00	23.00	2.736
3	28314	51.00	25.60	3.145
4	29032	51.00	25.60	3.145
5	28117	51.60	28.00	3.447
6	28158	65.20	25.20	4.068
7	28961	72.00	27.00	4.826