

HANDLE SECTIONS

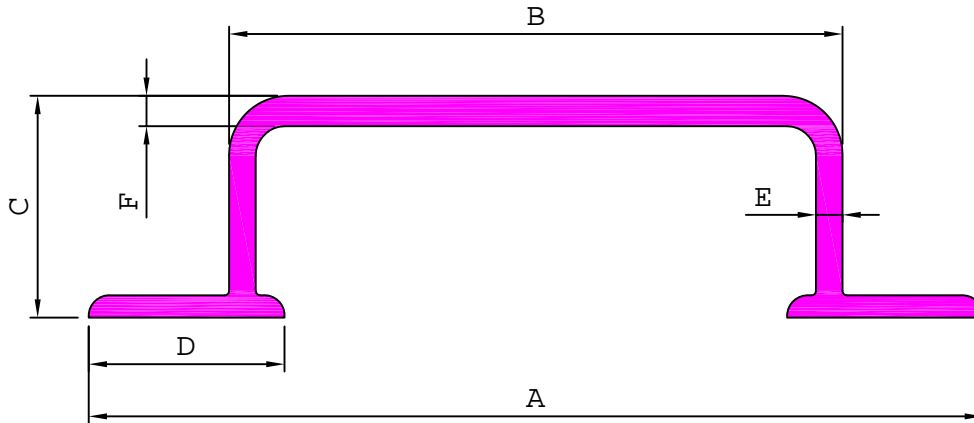

SL. No.	Section No.	A	B	C	D	E	F	Weight kg/m
1	18593	98.00	62.00	24.00	24.00	2.37	2.37	0.875
2	18661	122.00	80.50	29.00	27.00	2.80	2.80	1.248
3	18655	123.00	83.50	31.00	26.50	3.70	3.70	1.659
4	18662	142.00	97.00	29.50	30.00	3.00	3.00	1.476
5	18654	147.00	107.50	31.00	26.50	3.70	3.70	1.899
6	18586	148.80	106.50	33.00	27.30	3.90	4.20	2.105
7	18619	150.00	110.00	34.00	30.00	3.45	3.60	1.995
8	18572	150.00	110.00	34.00	30.00	3.66	3.66	2.127
9	18620	150.00	110.00	34.00	30.00	4.00	4.10	2.248

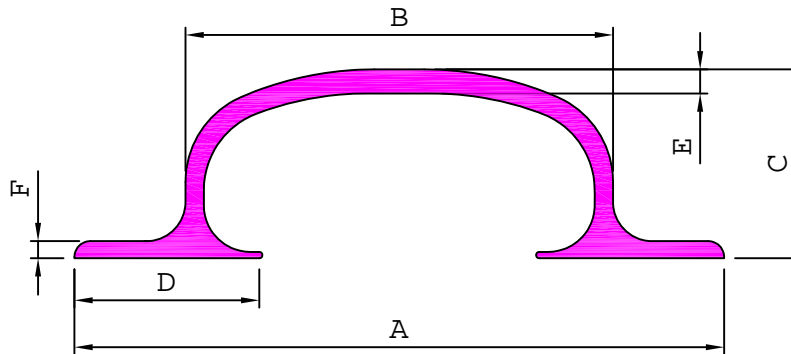

SL. No.	Section No.	A	B	C	D	E	F	Weight kg/m
1	18611	123.00	82.50	34.50	30.00	2.45	2.20	1.258
2	18613	128.00	84.00	37.00	30.00	3.50	3.10	1.724
3	18647	141.00	98.40	38.40	38.10	3.10	2.70	1.815
4	18648	126.50	84.00	36.50	35.00	3.10	2.70	1.598
5	18649	140.00	98.50	35.00	27.00	2.55	2.40	1.328
6	18650	142.40	98.40	38.40	38.80	3.10	2.80	1.837
7	18651	121.00	81.00	33.50	27.00	2.65	2.00	1.172
8	18652	140.00	98.00	35.00	28.20	2.95	2.70	1.524
9	18653	120.00	81.00	37.00	26.50	2.95	2.00	1.335
10	18656	140.00	98.50	31.70	27.00	2.50	2.30	1.252
11	18657	120.00	82.00	32.70	25.50	2.40	2.20	1.097
12	18660	101.00	65.30	28.10	28.00	2.65	2.10	1.018
13	18671	125.50	84.30	34.50	28.00	2.70	2.50	1.293

HANDLE SECTIONS

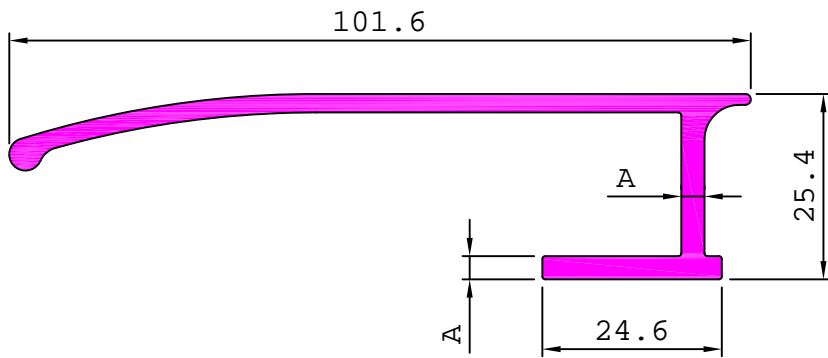

SL. No.	Section No.	A	Weight kg/m
1	18553	3.18	1.093
2	18604	2.10	0.852

18565

0.491 kg/m

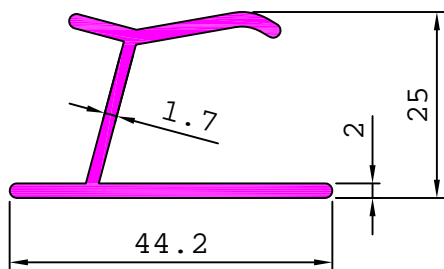

18641

0.707 kg/m

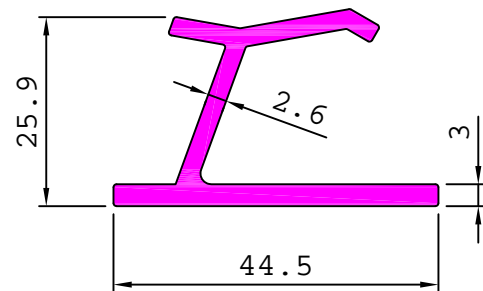

18576

1.074 kg/m

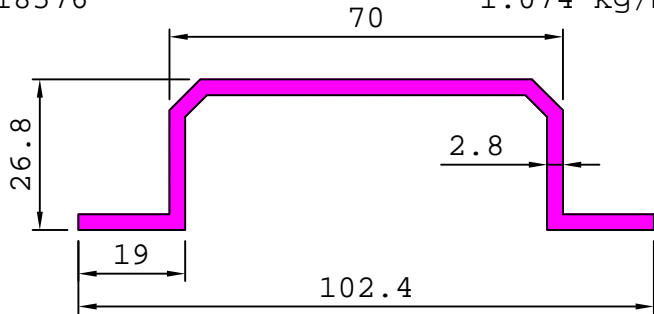

18558

1.438 kg/m

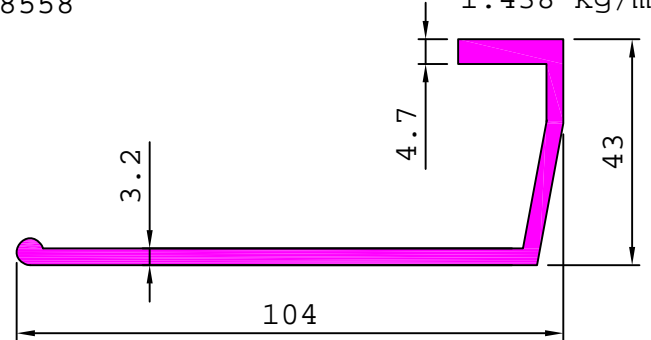

18560

1.709 kg/m

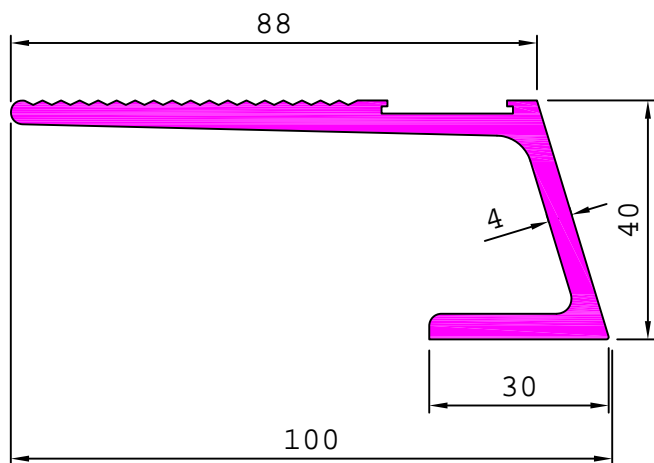

18570

0.942 kg/m

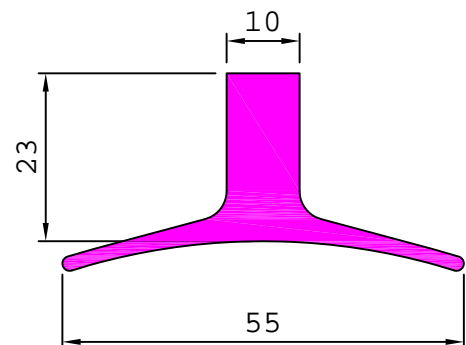

HANDLE SECTIONS

18645

4.700 kg/m

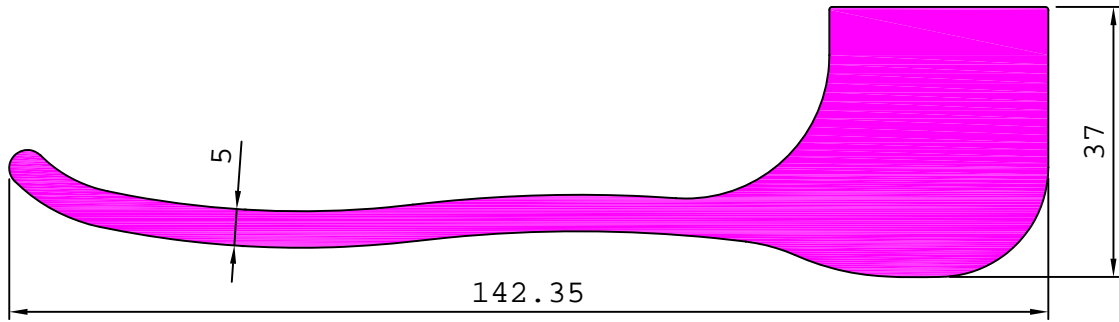

18643

7.668 kg/m

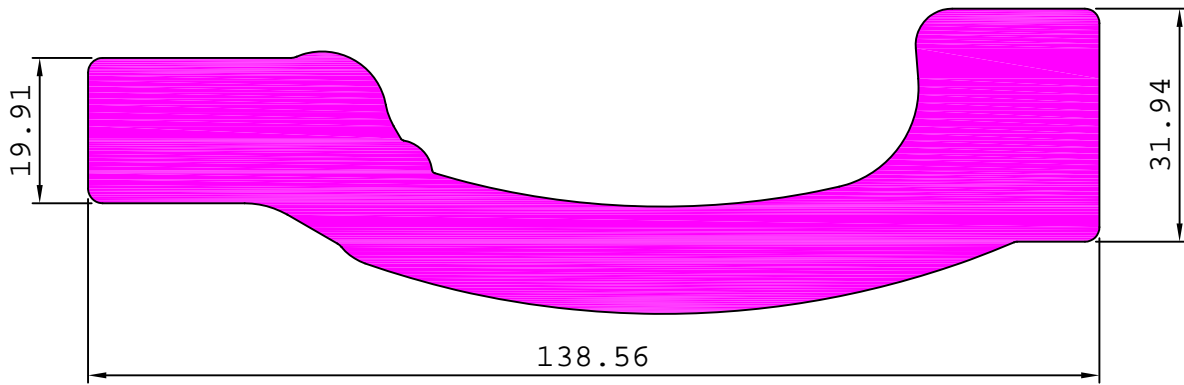

18644

9.441 kg/m

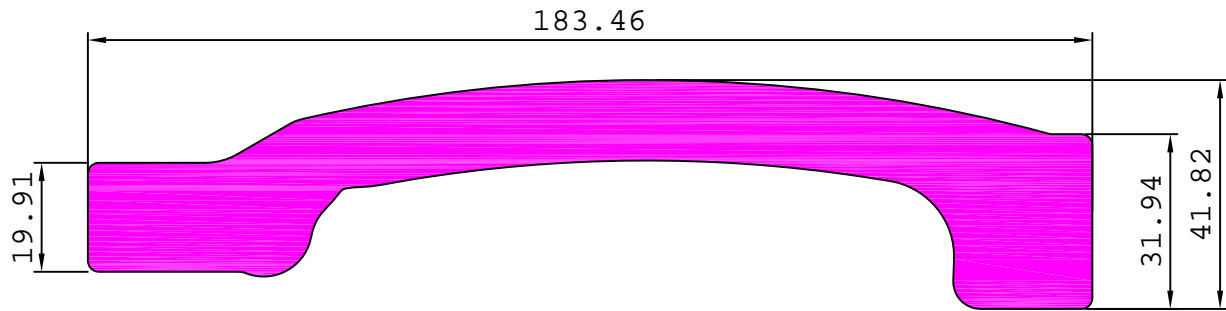

29426

13.076 kg/m

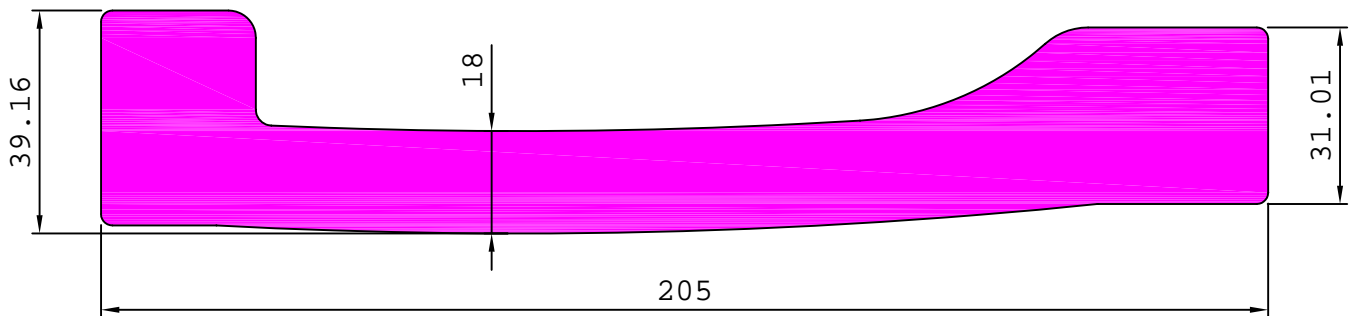

HANDLE SECTIONS

18646

1.579 kg/m

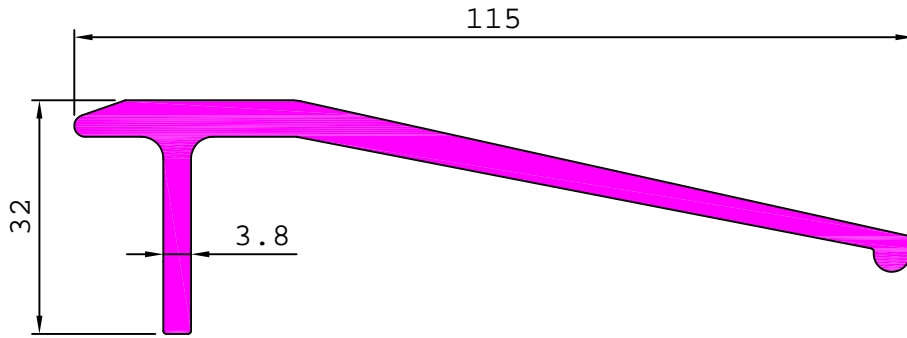

18658

1.411 kg/m

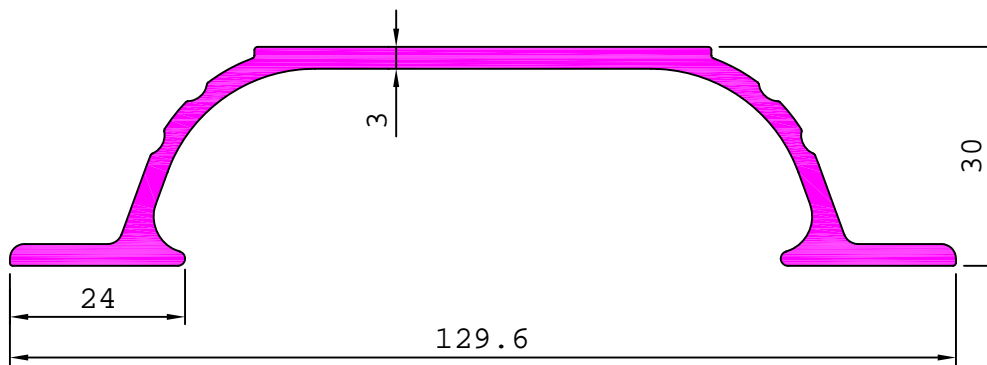

18659

1.613 kg/m

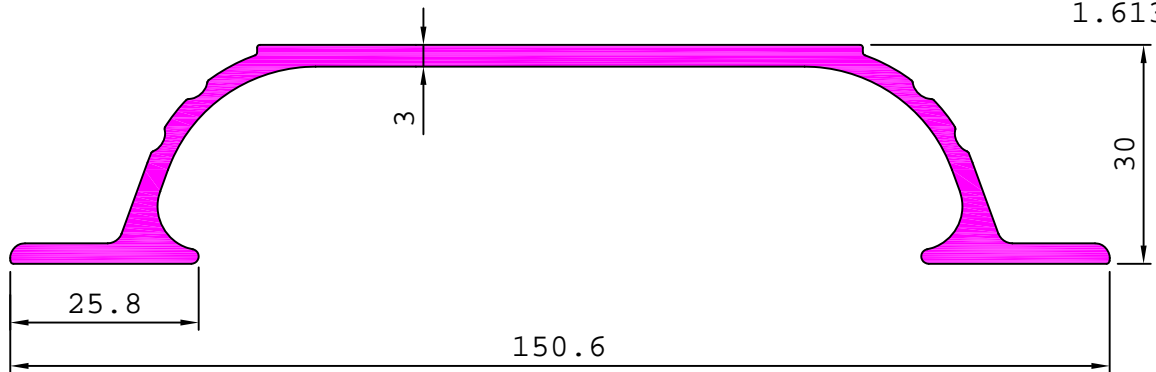

S5885

4.240 kg/m

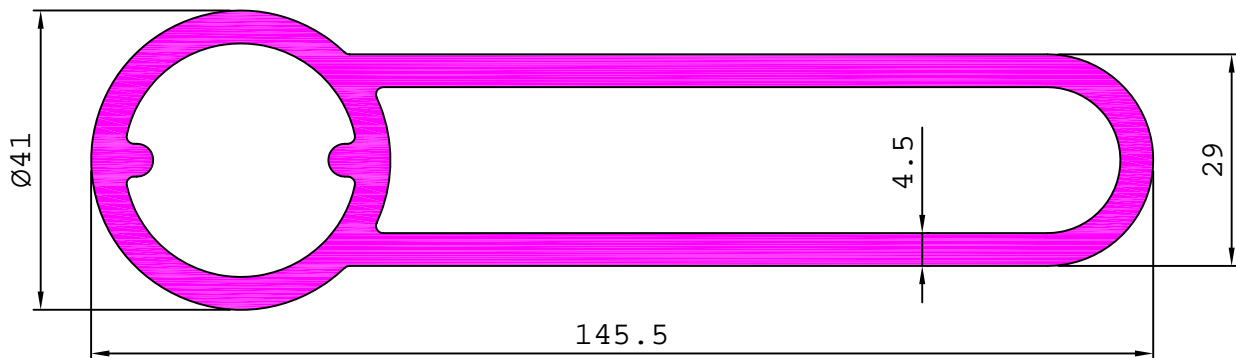

HANDLE SECTIONS

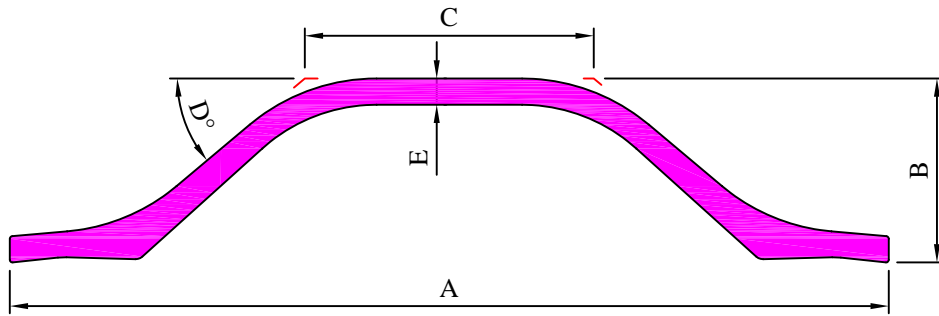

SL. No.	Section No.	A	B	C	D	E	Weight kg/m
1	18663	133.80	28.00	44.00	40.00	4.00	1.742
2	18664	154.50	27.30	64.00	38.50	4.10	2.031

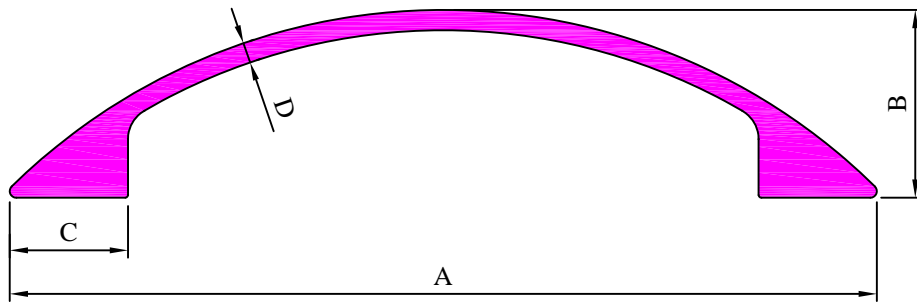

SL. No.	Section No.	A	B	C	D	Weight kg/m
1	18665	132.00	28.60	18.00	3.10	1.724
2	18666	151.80	29.00	18.30	3.20	1.855

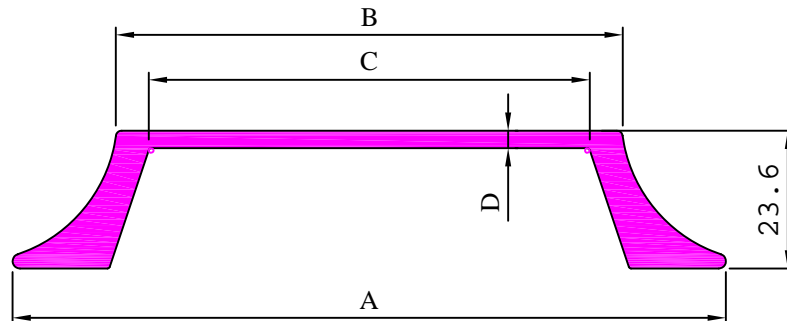

SL. No.	Section No.	A	B	C	D	Weight kg/m
1	18667	122.15	86.80	75.50	3.00	1.748
2	18668	150.75	114.00	102.60	3.20	2.063



HANDLE SECTIONS

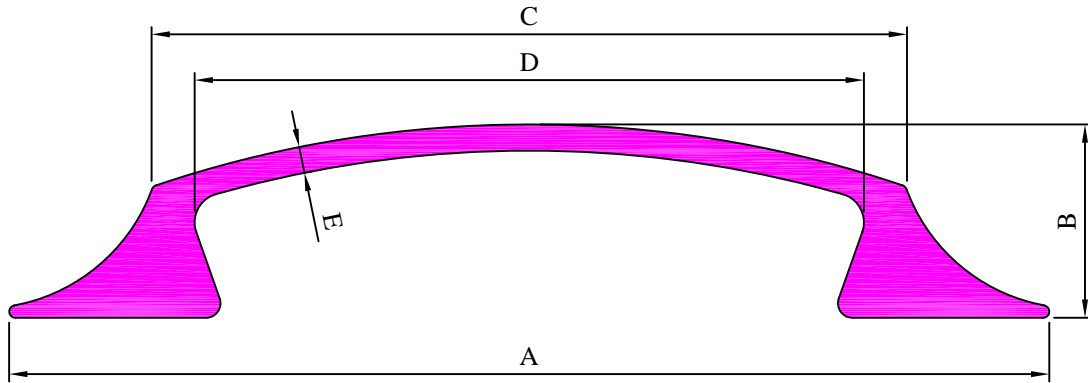

SL. No.	Section No.	A	B	C	D	E	Weight kg/m
1	18669	142.50	26.50	103.50	91.70	3.60	2.340
2	18670	164.25	28.00	128.70	111.50	3.50	2.771